



Department
for Education

GallifordTry

Woodlands Academy

Overview of
Planning
Application
Proposals



The redevelopment of The Woodlands Academy is funded by the Department for Education (DfE) as part of the School Rebuilding Programme and the project is being delivered by Galliford Try.

- The site currently operates as The Woodlands Academy, an academy for children aged 2-16 with special educational needs. The school has approximately 136 pupils and 62 full time equivalent staff. There will be no change to pupil and staff numbers as part of the proposals.
- The proposed development includes the demolition of the existing buildings and the erection of a 2 storey, L-shaped building with a floor area of approximately 3,300sqm.
- There are currently approximately 35 parking spaces at the site and no cycle parking or electric vehicle charging spaces. The proposed development will have 56 car and minibus parking spaces and 14 cycle parking spaces. Approximately 8 of the parking spaces will have EV charging points.
- Drop-off and pick-up are currently managed on site making use of the existing hard play area. The new school will have a dedicated drop off and pick up area within the site for cars and minibuses. This will improve the management of pupil drop off and pick up which will continue to take place on-site.
- The proposed development includes a new, additional access point for vehicles from Woodlands Drive, and a change to the existing access which will become for entry only.
- The new school building will help to tackle climate change through minimising energy demand and using low carbon and renewable energy solutions. This will include solar panels on the roof. The scheme will also include enhanced landscape planting.

Site Location

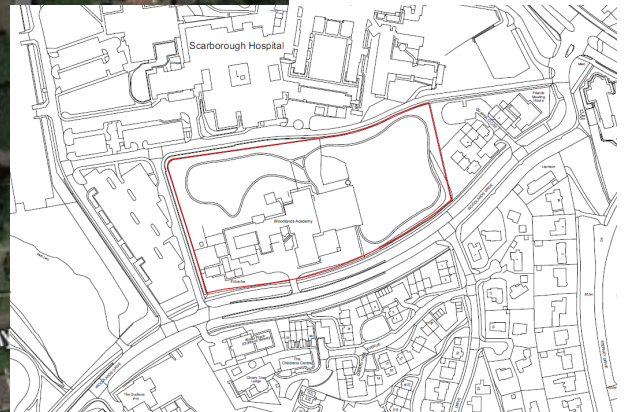
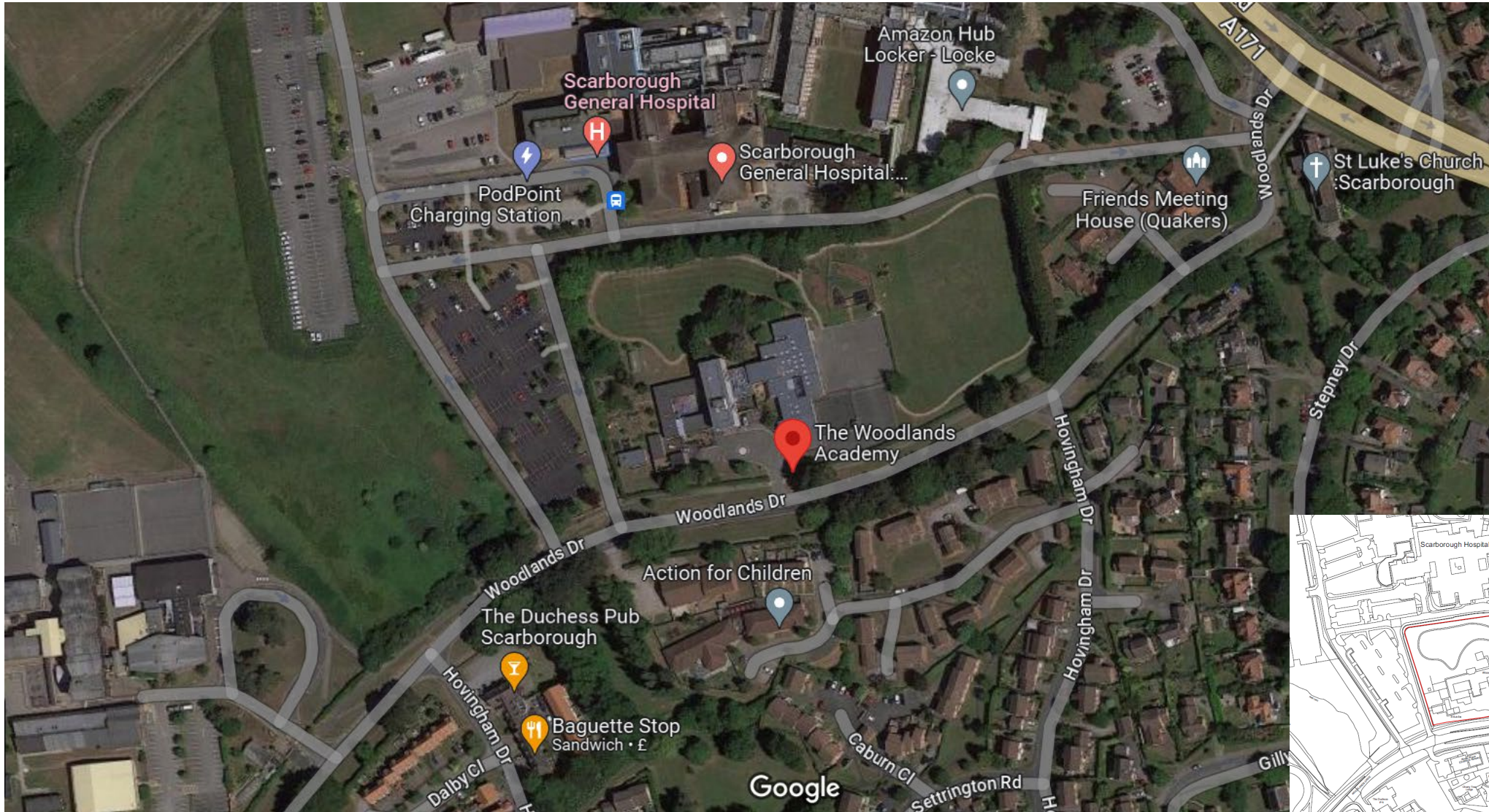

Proposed Site Masterplan



Site

- Planning Application Boundary
- (A) Pedestrian Entrance
- (B) Vehicle Parking
56No. total spaces incl. 2 accessible bays, 1 Minibus and 8 Drop-off/Visitor bays. 8 Active EV Spaces + 4 Passive EV Spaces
- (C) Pick-up/ Drop-off Zone
- (D) MUGA
46.7m X 23.2m
- (E) Playing Fields
Existing sports pitch markings repositioned
- (F) Existing Retained Play Equipment
- (G) Outdoor Classroom
- (H) Horticultural Area Retained
- (I) Nursery/Reception Play Area
Existing play equipment relocated
- (J) Primary Play Area
Existing play equipment relocated
- (K) Secondary Play Area
Existing play equipment relocated
- (L) Bin Store
No. TBC
- (M) Cycle Parking
10 Spaces
- (N) Visitor Cycle Parking
4 Spaces
- (O) Sprinkler Tank
- (P) Substation

Site Access and Circulation

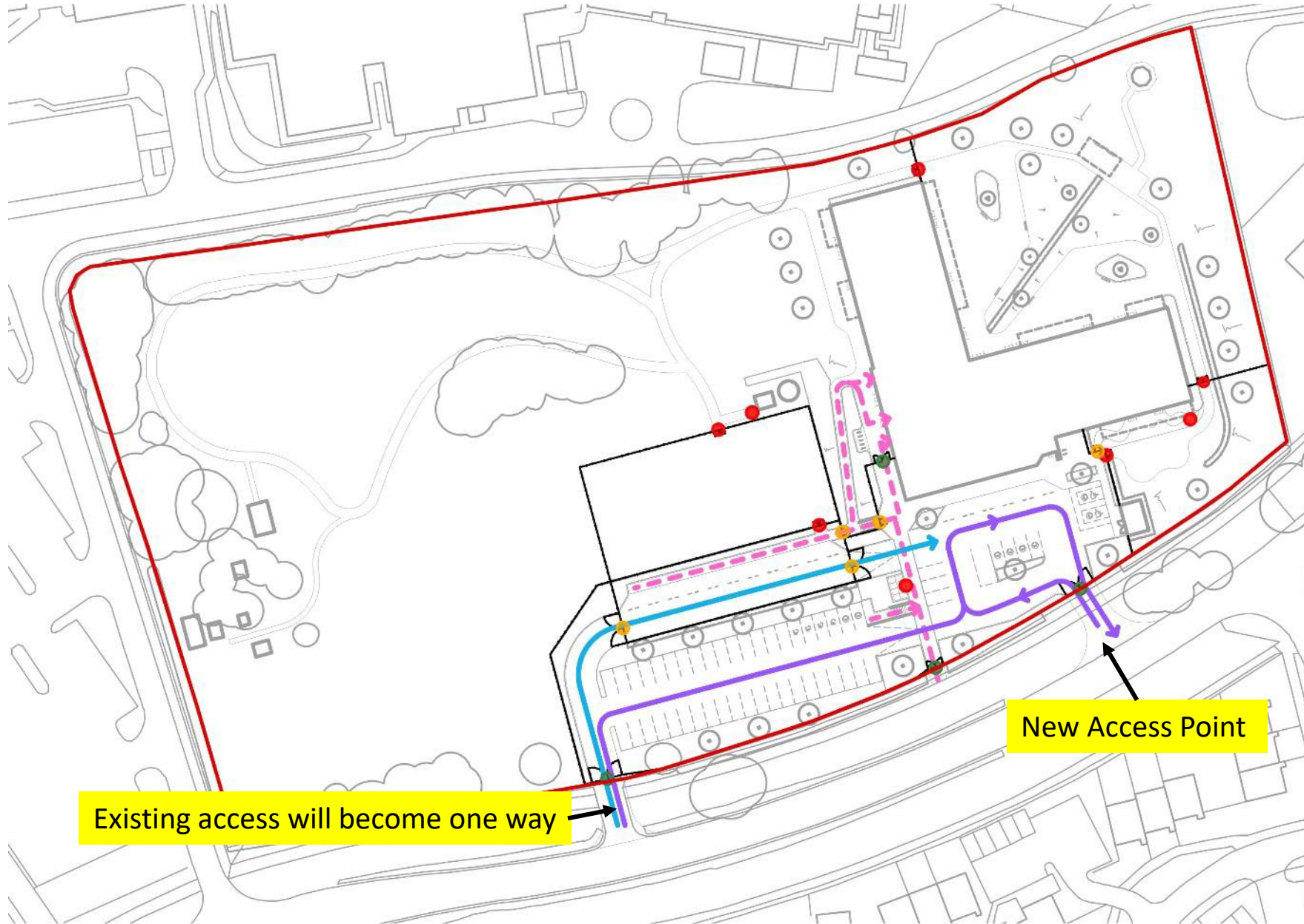

- Student Access
- Student Secure Drop-off
- Visitor/Staff Vehicular Access

- Open
- Managed
- Locked

- There will be no net increase in trips to / from the school as a result of the redevelopment proposals.
- The new vehicular access point will create a one-way loop within the site which will improve circulation for pupil drop off/pick up, staff and visitors.
- The proposals include a secure drop-off area for pupils which is separate to the car parking.
- The access, circulation and parking improvements at the site will have a positive impact on the operation of Woodlands Drive.

New School Access Details



- The new vehicular access point will accommodate two way traffic and will be designed to ensure that there is suitable visibility for vehicle drivers.
- The new access will be installed early in the build process to allow it to be used for construction traffic.
- The new access will be set at a suitable distance from the Hovingham Drive junction.
- In order to create the access there will be a need for ground works and for some underground cables/pipes to be moved. This may affect the roots of some trees but we are looking at how we can avoid this.

Existing and Proposed Parking Spaces





Existing Parking

Proposed Parking

 Drop Off / Visitor
6 Spaces

 Area used for drop-off/pickup

 Staff Parking
28 Spaces

 Drop Off / Visitor
8 Spaces

 Area used for drop-off/pickup

 Accessible Parking
1 Spaces

 Staff Parking
45 Spaces

 Substation Service Parking
1 Spaces

 Accessible Parking
2 Spaces

Electric vehicle parking
- 8 charging points (including accessible parking)
- 4 future charging points

 Minibus Parking
1 Space

Cycle parking
- 10 staff and pupil spaces (covered)
- 4 visitor spaces (not covered)



Scheme Visual – Main Entrance



Scheme Visual – Principal Elevation



Scheme Visual – Rear Elevations



Scheme Visual – Teaching Wing and External Teaching Area



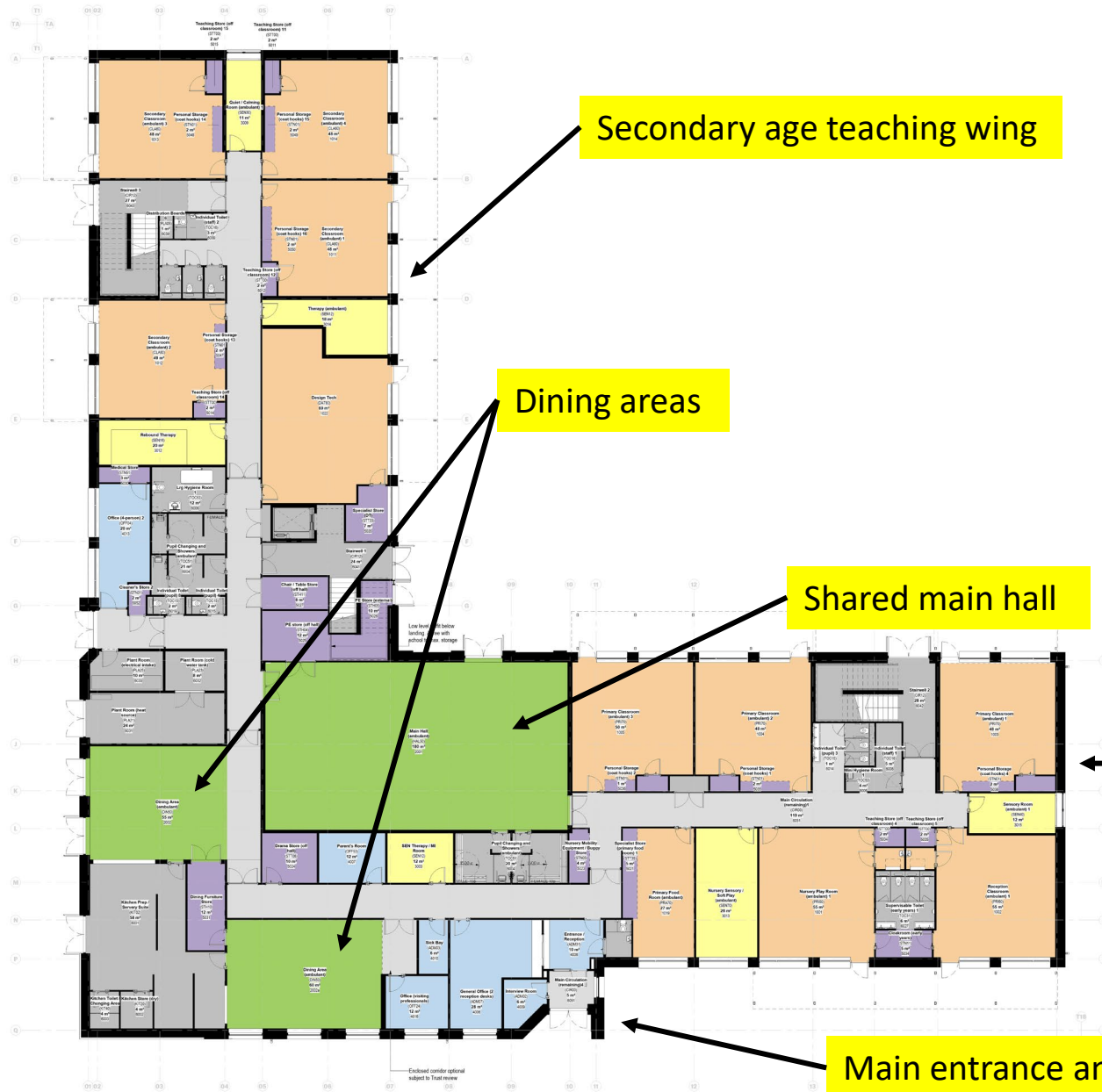

- The new building will significantly improve upon the existing buildings at the site which are no longer fit for purpose and are at the end of their operational life.
- The new building will be fit for purpose and bespoke to the special educational needs of the pupils. It will include subject specific teaching spaces (e.g. ICT and design technology), as well as sensory and therapy rooms.

Nursery and primary age teaching wing

Main entrance and reception

First Floor Plan

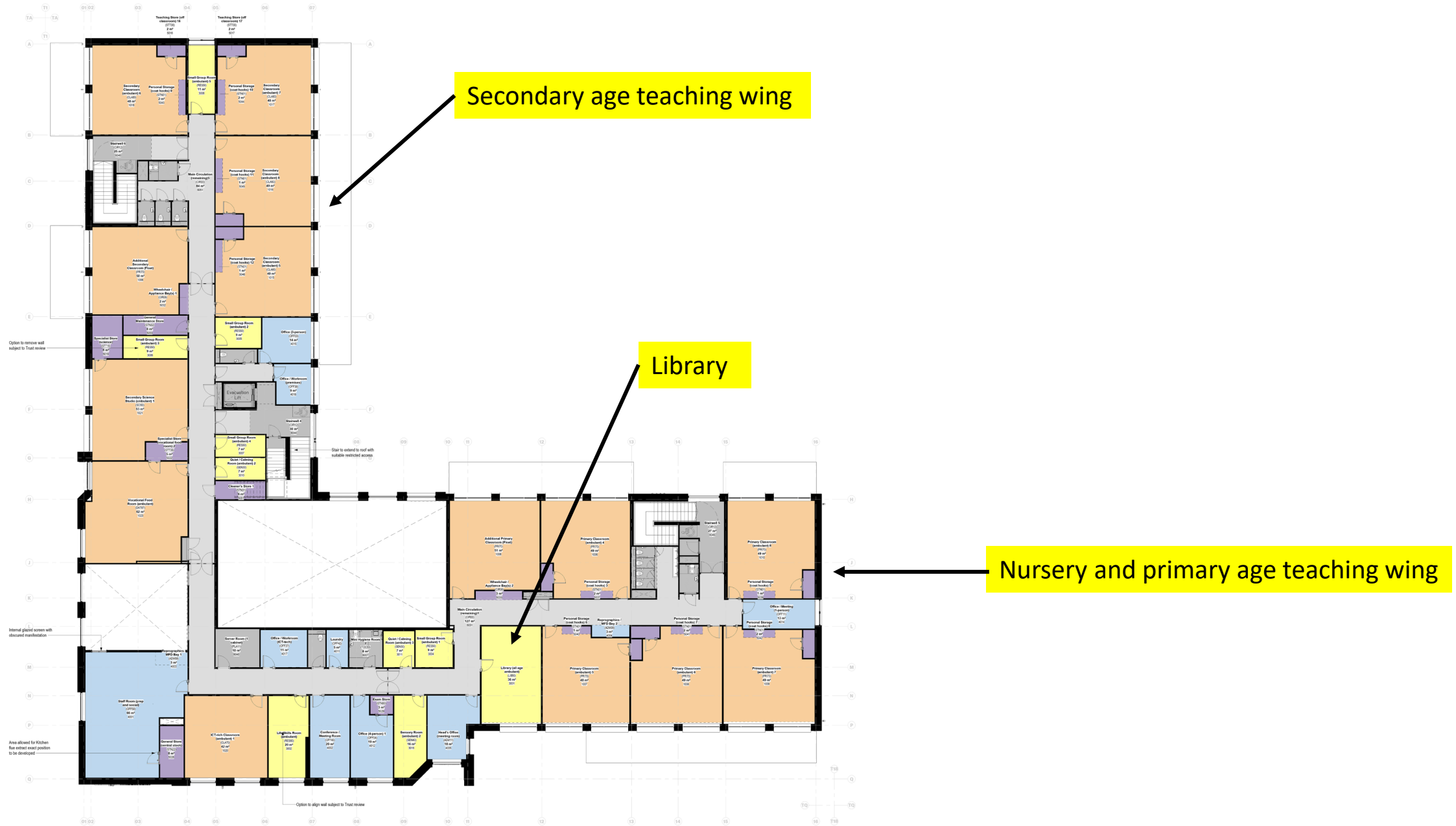

Secondary age teaching wing

Library

Nursery and primary age teaching wing

Elevations – North and East

Elevations Legend

- 1 Facing Brickwork (Buff Blend)
- 2 Facing Brickwork (Dark Grey)
- 3 PPC Double Glazed Aluminium Windows/Doors (dark grey)
- 4 PPC Aluminium Curtain Walling (Stick System - Dark Grey) ('Infill' - Glazed, Glazed Spandrel, Glazed in Louvre)
- 5 Projecting Soldier Course
- 6 PPC Aluminium Parapet Coping Flashing (Dark Grey)
- 7 Plant arrangement to the rear TBC (Shown indicatively only)
- 8 Feature Timber Aesthetic Cladding
- 9 School Logo / Graphics (Illuminated Signage)
- 10 Contrasting Colour reveal Flashing to Curtain Wall Jamb and Head (Colours TBD - Locations ref. 4 TBC)
- 11 Rainwater pipe and hopper - Final provision and locations subject to capacity calculations.
- 12 Aluminium Louvres - Final provision and locations subject to detailed MEP design
- 13 Canopy to Ground Floor classrooms
- 14 Canopy to Visitor Entrance
- 15 Student Entrance
- 16 30mm Recessed Solder Course
- 17 Cladding System - Opus RAL 7016 Anthracite (Euroclad) TBC

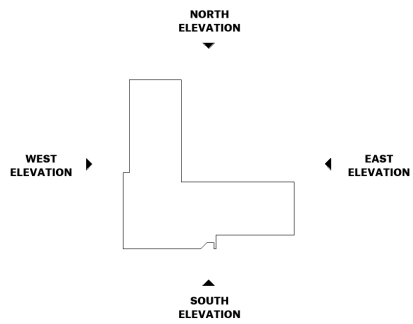

Elevations – South and West

Elevations Legend

- 1 Facing Brickwork (Buff Blend)
- 2 Facing Brickwork (Dark Grey)
- 3 PPC Double Glazed Aluminium Windows/Doors (dark grey)
- 4 PPC Aluminium Curtain Walling (Stick System - Dark Grey) ('Infill' - Glazed, Glazed Spandrel, Glazed in Louvre)
- 5 Projecting Soldier Course
- 6 PPC Aluminium Parapet Coping Flashing (Dark Grey)
- 7 Plant arrangement to the rear TBC (Shown indicatively only)
- 8 Feature Timber Aesthetic Cladding
- 9 School Logo / Graphics (Illuminated Signage)
- 10 Contrasting Colour reveal Flashing to Curtain Wall Jamb and Head (Colours TBD - Locations ref. 4 TBC)
- 11 Rainwater pipe and hopper - Final provision and locations subject to capacity calculations.
- 12 Aluminium Louvres - Final provision and locations subject to detailed MEP design
- 13 Canopy to Ground Floor classrooms
- 14 Canopy to Visitor Entrance
- 15 Student Entrance
- 16 30mm Recessed Solider Course
- 17 Cladding System - Opus RAL 7016 Anthracite (Euroclad) TBC

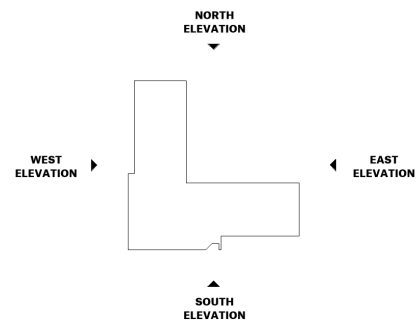

South Elevation
1:100



West Elevation
1:100

- The proposals have been designed to target a Net Zero Carbon in Operation standard.
- The design will meet minimum building fabric standards in excess of building regulations, including high levels of airtightness and insulation, controlling solar gain and utilising thermal mass to minimise heating demand and the risk of overheating in warmer months.
- Natural ventilation will be used wherever possible. Mixed mode ventilation will be used in all teaching spaces to maintain thermal comfort.
- High efficiency LED lighting coupled with occupancy and daylight controls will significantly reduce lighting energy use.
- Low carbon energy will be generated through the inclusion of solar panels on the roof of the building.
- The provision of heating and hot water will be from electrical solutions eliminating the requirement for the use of fossil fuels.
- Good daylight will be achieved in occupied spaces through the balanced and considered use of glazing avoiding excessive heat gain / losses.
- Water efficient fixtures and fittings will be specified to reduce water consumption.
- Materials that are durable and resilient will be specified to maximise their life span and avoid the need for disposal / replacement.
- Appropriate and accessible refuse facilities will be provided to encourage occupants to recycle waste effectively.
- Cycle parking and electric vehicle parking spaces will be provided to encourage sustainable travel choices.
- Significant landscape planting will contribute to an increase in biodiversity and greening of the development.

Construction Phasing - Overview

Site Logistics – New access construction



- The first phase of construction is due to commence in Summer 2024 and will be the formation of a new permanent access point for vehicles into the eastern portion of the site from Woodlands Drive. There will also be the need for a second temporary construction access.

Site Logistics – Section 1 - New building Construction

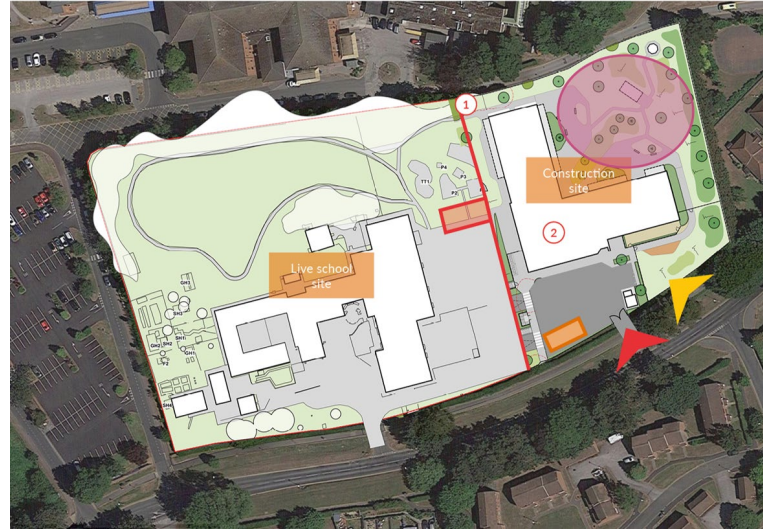

- The second phase will be the construction of the new school building and surrounding landscape. The existing buildings and the western portion of the site will remain in use by the school until the new building is operational.

Site Logistics – Section 2 – Demolition / Landscaping

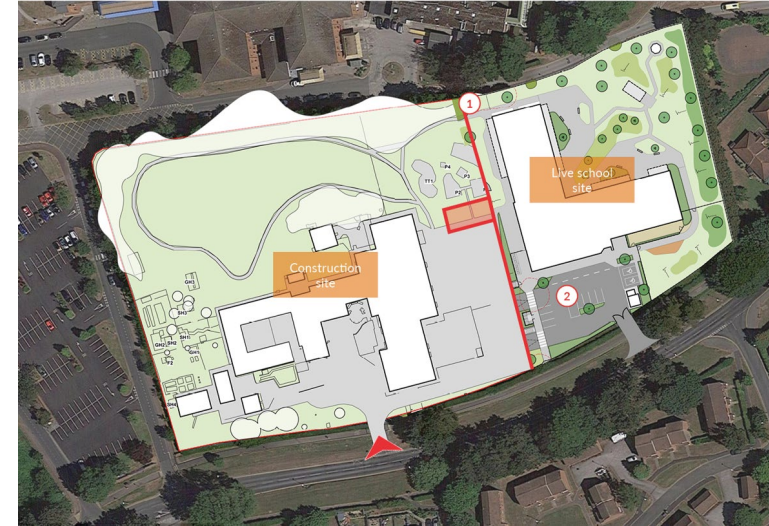

- The third phase of construction will take place once the school has moved into the new building. The existing buildings will be demolished, and the landscaping will be completed across the site.

- During all phases of construction, Galliford Try will carefully manage construction traffic and vehicles to ensure that there are limited impacts on the operation of Woodlands Drive, including through avoiding the arrival or departure of site traffic and deliveries during the morning and afternoon drop-off and pick-up periods for The Woodlands Academy and Graham School.

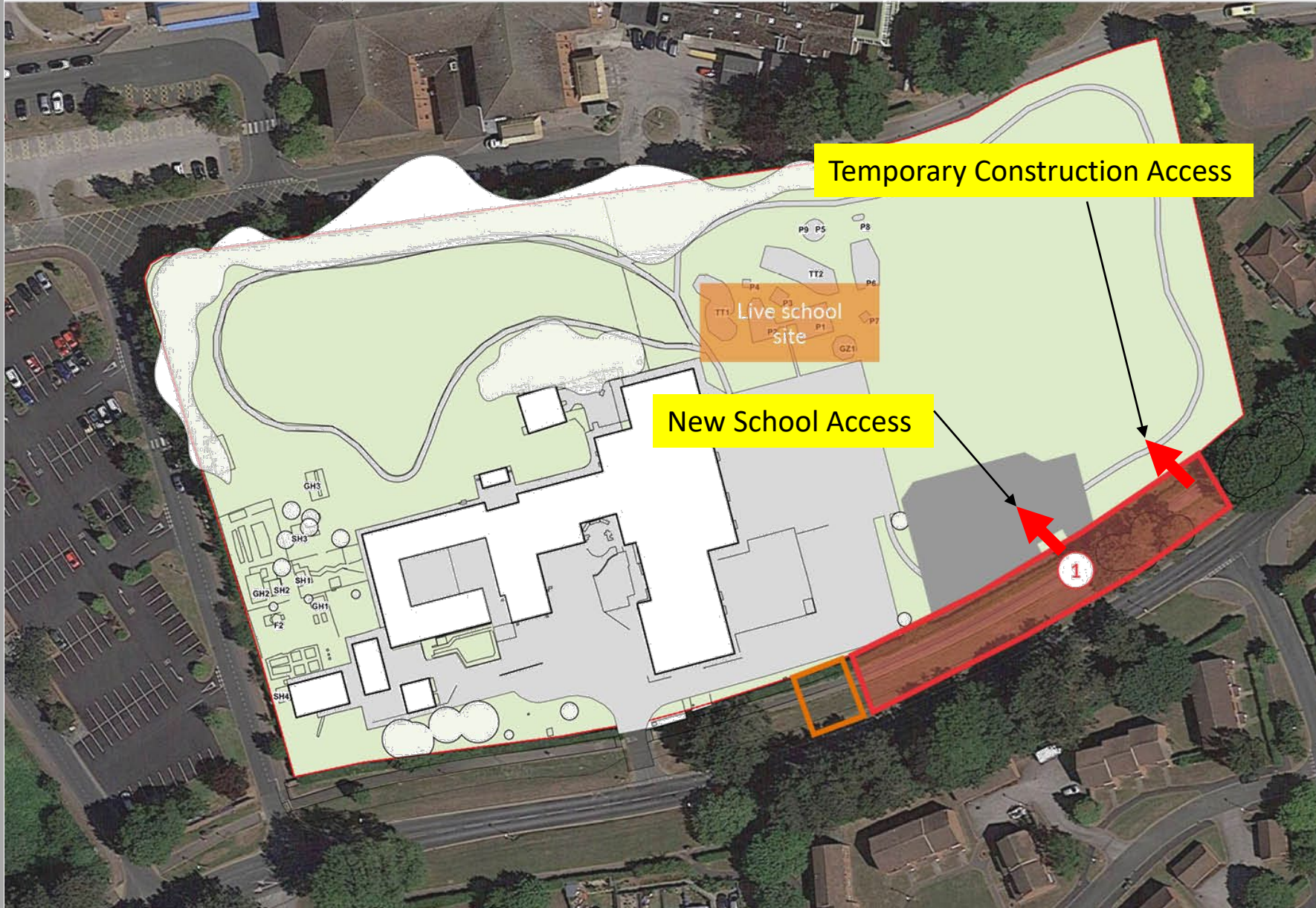

- During the first phase of development, new access points into the site from Woodlands Drive will be constructed – the new permanent school access and a second temporary construction access.
- The footpath to the north of Woodlands Drive will be closed in this area for a short period whilst the works take place. There may also be occasional lane closures in the road. Any necessary closures would be kept to a minimum and agreed with the Local Highway Authority in advance. Alternative safe pedestrian routes will be provided in the event of any footpath closure.
- The new carpark will be constructed once the access points are operational.
- The school will operate as usual across the remainder of the site during this phase.

Site Logistics – Section 1 - New Building Construction

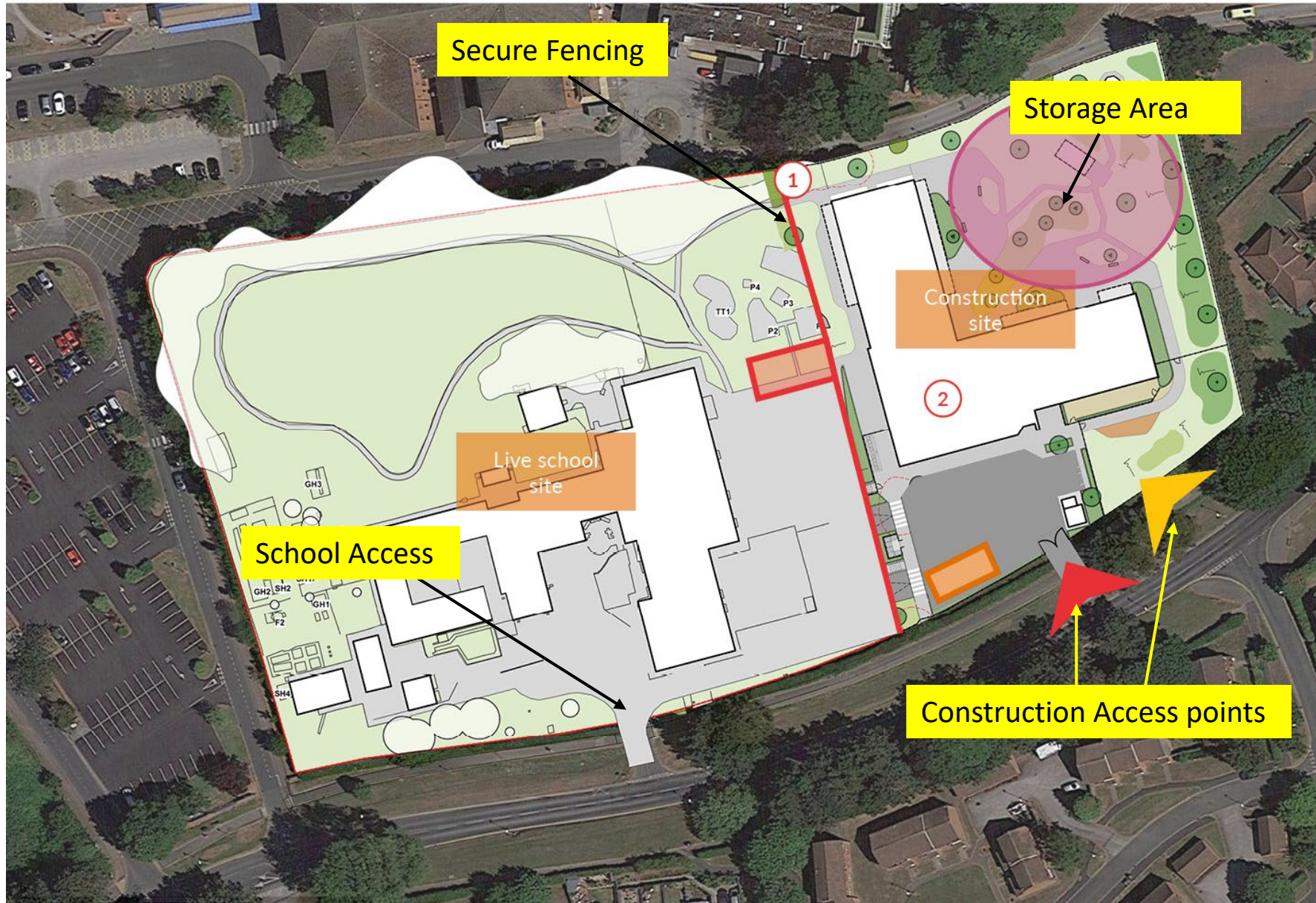

- During the second phase of construction, the eastern portion of the site will be fenced off with a hoarding to create a secure construction site. Construction vehicles will be accommodated in this part of the site
- The school will continue to use the existing buildings and will operate within the western portion of the site.
- School drop off and pick up will continue to take place within the school site using the hard court area as it does currently.
- Staff parking will be as existing and construction staff will park off site. Our surveys have shown that there is sufficient space for this in the nearby streets around Hovingham Drive (we counted over 190 unused parking spaces during a typical working day, far in excess of the expected number of construction staff).

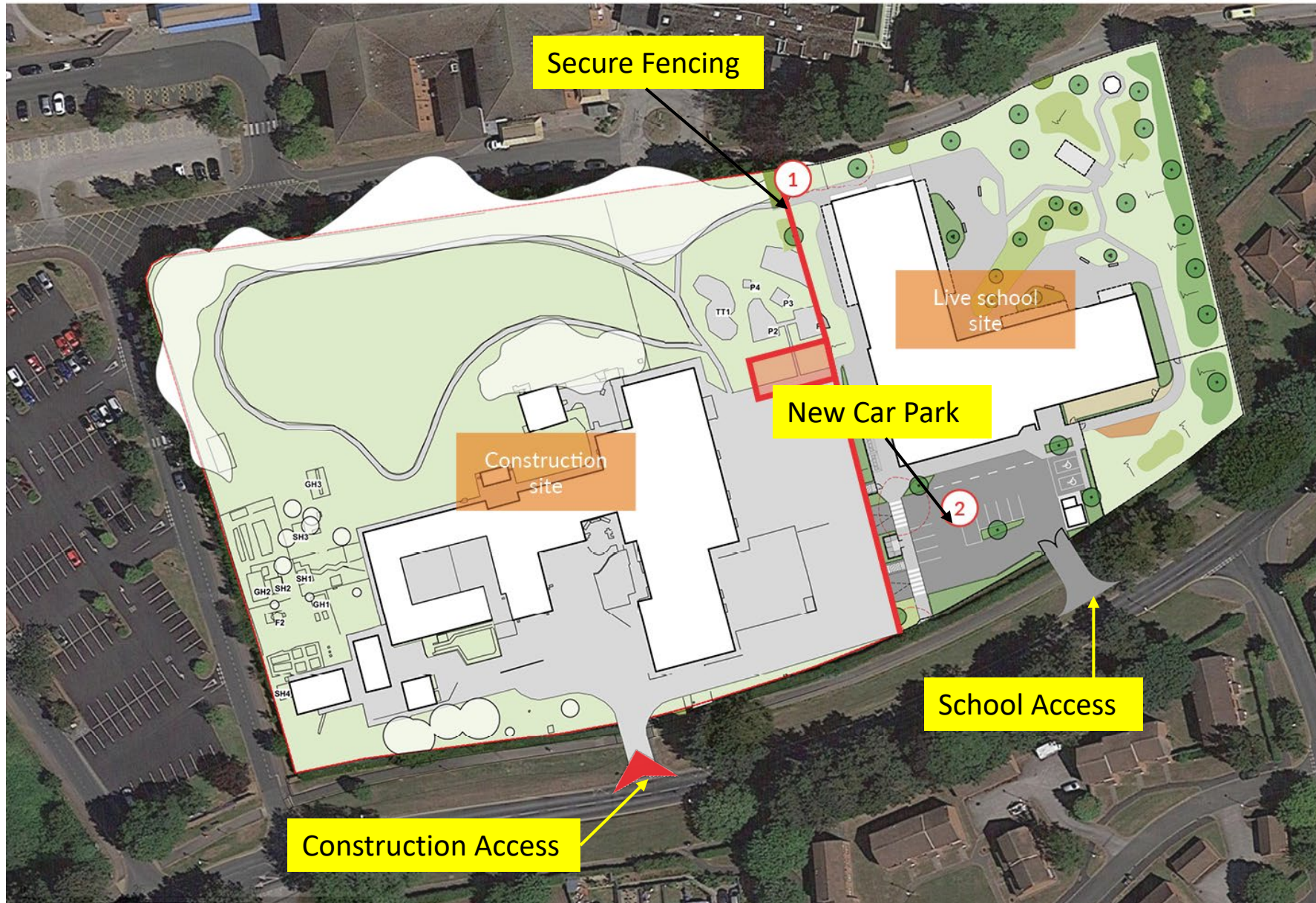

- During the final phase of construction, the school will occupy the new building and the eastern portion of the site.
- The western portion of the site will become the secure construction site so the existing buildings can be demolished and the new drop-off area, staff car park, hard court and areas of landscaping can be constructed.
- During this phase, there will be a limited number of parking spaces for staff in the new car park therefore some staff will need to park in the nearby streets around Hovingham Drive (our surveys have shown that there is sufficient space for this).
- School pick up and drop off will take place on-site in the new car park.

Completed Scheme



Site

- Planning Application Boundary
- (A) Pedestrian Entrance
- (B) Vehicle Parking
56No. total spaces incl. 2 accessible bays, 1 Minibus and 8 Drop-off/Visitor bays. 8 Active EV Spaces + 4 Passive EV Spaces
- (C) Pick-up/ Drop-off Zone
- (D) MUGA
46.7m X 23.2m
- (E) Playing Fields
Existing sports pitch markings repositioned
- (F) Existing Retained Play Equipment
- (G) Outdoor Classroom
- (H) Horticultural Area Retained
- (I) Nursery/Reception Play Area
Existing play equipment relocated
- (J) Primary Play Area
Existing play equipment relocated
- (K) Secondary Play Area
Existing play equipment relocated
- (L) Bin Store
No. TBC
- (M) Cycle Parking
10 Spaces
- (N) Visitor Cycle Parking
4 Spaces
- (O) Sprinkler Tank
- (P) Substation